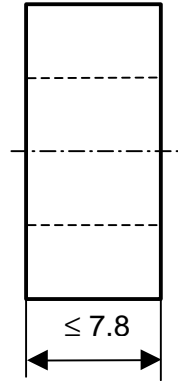
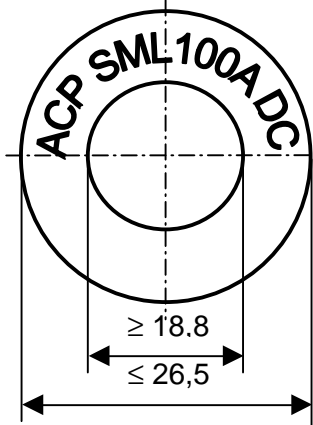

Subject:	CT core		Customer:	ACP	
Item No.:	M-105	Index:	02	Customers part No.:	ACP SML100A

**1. Mechanical outline:**

Nominal dimensions of core:  
 $25,0^{\pm 0,5} \times 20,0^{+0,2, -0,1} \times 6,5^{+0,2, -0,1}$  mm

DC: Date Code by IEC 62 5.1

[dimensions] = mm

**2. Product-type:** Epoxy-coated core

**3. Core material:** VITROVAC 6150 F or AMT 302 (Co-amorphous,  $B_{sat} = 1.0$  T)

**4. Nominal values:**

$l_{Fe}$	=	7,07	cm
$A_{Fe}$	=	0,13	cm <sup>2</sup>
$m_{Fe}$	=	7,28	g
$\eta_{Fe}$	=	0,80	/

**5. Guaranteed values:**  $1.300 < \mu_{abs} < 1.600$  at  $f = 50$  Hz and  $H_{max} = 1,0$  A/cm

**6. Inspection values:**  $I_{RMS} \times N1 = 5,0$  A ( $H_{max} = 1,0$  A/cm) at  $f = 50$  Hz

$0,424$  mV/turn.  $\leq U_{AVG} \leq 0,523$  mV/turn

**7. Marking:** Marked with "ACP SML100A JM" (JM= Year/Month of production)

**8. Packaging:** 48 pcs/layer / 5 layers per box

Ausgabe:	Änderung:	Datum:	Name:
00	Index: 01	11.05.2001	R. Juhász
01	Index: 02; Kennzeichnung: ACP SML100A JM	25.07.2001	Á. Kovách

Created Date: 25.07.01

Name: Á. Kovách

Checked Date: 25.07.2001

Name: Frau Tóth Cs. M.

Released Date: 25.07.2001

Name: Dr. M. Ferch